

Non-technical Summary

Introduction

Southern Gas Networks (SGN) is applying for development consent to replace the existing gas pipelines crossing the Western Solent from Lepe in Hampshire to Gurnard on the Isle of Wight (Figure 1.1 'Proposed Scheme'). As a licensed Gas Transporter, SGN has a statutory duty to ensure a safe and secure supply of gas to all of its customers. Due to ground instability issues and increasing vulnerability of the existing pipelines to exposure and scour on the seabed, the pipelines need to be replaced and the existing Pressure Reduction Station (PRS) at Egypt Point on the Isle of Wight moved to a more stable location to maintain the security of supply.

The proposed scheme will comprise the replacement of three existing high pressure gas pipelines, a new PRS at Gurnard, connections to the existing Gas Distribution Network and removal of the existing PRS at Egypt Point.

An Environmental Statement (ES) has been prepared to document the statutory Environmental Impact Assessment (EIA) process and to report the likely environmental effects associated with the scheme. The ES will be submitted with the consent applications. This document is the summary of the key issues raised in the ES in non-technical language, and is available as a standalone document.

An application for development consent will be made to the Secretary of State for Energy and Climate Change (DECC) under The Public Gas Transporter Pipe-line Works (EIA) Regulations 1999 and to the Marine and Fisheries Agency (acting on behalf of the Secretary of State for the Department of Food and Rural Affairs) under The Marine Works (EIA) Regulations 2007 for the replacement of the pipelines. Planning consent for the proposed PRS off Rew Street in Gurnard, will be sought from the Isle of Wight Council. Applications will also be submitted to the Marine and Fisheries Agency, under the Food and Environment Protection Act 1985 for consent for the pipeline construction works including temporary installation of marine guidance systems on the seabed, and under the Coast Protection Act 1949, for any works below mean high water springs that might affect navigational issues.

Alternative Options

Four alternative options for maintaining the supply of gas to the Isle of Wight were considered as follows:

- Option 0: Do Nothing: no intervention to maintain the gas supply to the island.
- Option 1: Replacement of the Existing Gas Pipelines and Relocation of the PRS: installation of replacement gas pipelines across a distance of 3.9km from Lepe to Gurnard with a number of different construction techniques were considered including trenching, tunnelling and drilling beneath the seabed. **Option 1** was chosen as the preferred option with the preferred solution to drill all the way beneath the seabed.
- Option 2: Works to stabilise the ground at Egypt Point comprising construction of a rock bund to prevent further coastal erosion. This option does not address the risk of failure of the existing sub-sea pipelines.
- Option 3: Providing Gas Supply to the IoW with Liquid Natural Gas, possibly between Gurnard Head and Thorness Bay.

Three types of pipeline material were reviewed, but only welded carbon steel with suitable protective coating and cathodic protection, has regulatory approval for high pressure gas transmission and is deemed suitable for use. Alternative drilling methods and working areas in Hampshire and the IoW were also considered. To ascertain ground conditions in the proposed working area from Lepe in Hampshire, SGN undertook a trial drill during winter 2008/2009. This comprised a 1.3km drill from the same site as currently proposed and has provided vital information and given increased confidence in the viability of a long Solent crossing by directional drilling.

Description of Scheme

The proposed scheme involves directional drilling at a typical depth of 50m beneath the seabed to replace the three existing gas pipelines, a new PRS, removal of the existing PRS and connections to the existing gas network. In summary, the scheme involves the following works (see Figure 1.1 and the engineering drawings in Annex A):

Marine Works

- Installing two 324mm steel pipelines beneath the seabed by drilling from either side of the Solent (Lepe and Gurnard) and steered using temporary guidance systems to meet in the middle of the Solent; and
- Decommissioning the existing three steel pipelines.

Works in New Forest, Hampshire

- Setting up of a temporary working site for a drill-rig in a large agricultural field to the south of the existing gas station and north of Lepe Country Park (see Plate 1). Access will be via a private lane off Stanswood Road, Lepe;
- Pipe storage and stringing area (see Plate 2), whereby the pipes will be welded together before being pulled into the drilled hole (bore) by means of the drill rig site on the Isle of Wight;
- Connecting into the existing gas supply at a valve station adjacent to the drill-rig site, with 150m of open cut trenching across agricultural land; and
- Upgrading the existing pipework at the existing valve station.

Plate 1: Drill rig site at Lepe

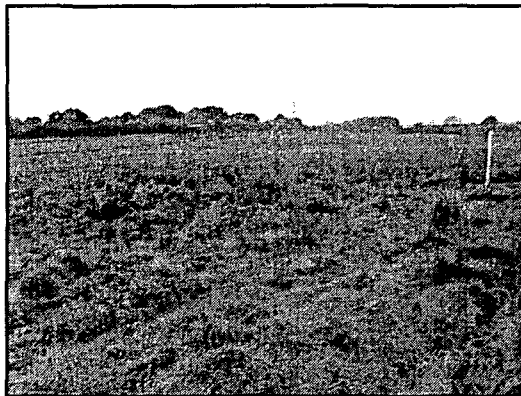

Plate 2: Proposed stringing area, Lepe



Works on the Isle of Wight

- Setting up of a temporary working site for a drill-rig (in a large agricultural field south of Hornhill Copse, Gurnard, accessible off Rew Street (see Plate 3). A 354m stringing area will also be required within this site.
- Connection and upgrades to the existing gas network. This will be via a single steel pipeline carrying gas at intermediate pressure, installed by a 500m length directional drill extending beneath Rew Street and the Gurnard Luck Valley, and then by open cut trenching across Cockleton Lane and agricultural land to connect to the existing gas network east of Gurnard village at Tuttons Hill.
- Construction of a new permanent PRS compound and infrastructure (within the same agricultural field as the temporary working site, to include construction of three single storey pre-fabricated buildings with flat roofs, additional installations/equipment within the new compound and a permanent concrete access road 4m wide, with a vehicle turning tee. The site will be surrounded by a 3m high mesh security fencing to contain the buildings and installations, which will be surrounded by a post and rail fence running from the entrance to Rew Street, with low shrubs planted around the fencing. Native trees will be planted to provide landscaping and screening.
- Decommissioning the existing PRS at Egypt Point (see Plate 4) in late 2011 involving the removal of the PRS building, and 'making safe' associated infrastructure.

The proposed works will commence in Summer 2010, subject to the necessary consents being in place. The drilling of the pipes will require 24 hour working 7 days a week for an estimated period of 6 months with the entire construction period extending over approximately 12 months.

The proposed scheme is to be constructed within or adjacent to areas of significant nature conservation, landscape and recreational importance, with some elements of the works located within the New Forest National Park and the IoW Area of Outstanding Natural Beauty (AONB).

Consultation

Effective consultation was central to the development and design of the scheme in order to arrive at a scheme that is acceptable to as many parties as possible and to engage those parties in the process. During the development of the scheme, consultation was undertaken with statutory consultees (Natural England, Environment Agency and English Heritage) and key organisations including Hampshire County Council, the IoW Council and the New Forest National Park Authority.

Comments received at all stages in consultation have been taken into account in the finalisation of the preferred scheme, leading to the preparation of this ES.

Consultation will be continued with statutory consultees, key organisations, landowners, residents and the general public as follows:

- 25 February 2010 – a public meeting at Gurnard to introduce the scheme to residents and interested consultees, and to provide an opportunity to discuss the proposals.
- Late Spring/Early Summer 2010 – if necessary, a further public meeting will be held at Gurnard and a public meeting held at Lepe to provide an update on the progress of the scheme and to discuss any concerns. Information on the proposed scheme and its construction will also be made available on signs within Lepe Country Park and at Gurnard.

The Existing Environment, Impacts and Mitigation

Figures 17.1 to 17.5 show the environmental constraints and opportunities associated with the proposed scheme.

Water

The accidental spillage of materials during construction has the potential to result in deterioration in water quality of ponds and standing water adjacent to the stringing area at Lepe. However, following standard best practice methods to minimise the risk of pollution, a pollution event is highly unlikely and the overall impact on water is negligible.

Flora and Fauna

The proposed pipeline will be drilled at an approximate depth of 50m beneath the seabed and will therefore avoid impacting upon the interest features of the internationally designated conservation sites. The proposed scheme is therefore not anticipated to affect any marine wildlife or fisheries and therefore this has not been considered within the environmental assessment. In addition, there is no potential for drilling lubricant to leak through into the marine environment due to the depth of the drill.

The terrestrial components of the proposed scheme will be constructed predominantly in areas of agricultural land but also adjacent to woodland, standing water, meadows and pasture. The scheme will involve the felling of an estimated 10 trees on the IoW and 2 trees (in addition to a small group of young trees) in the New Forest and the removal of some hedgerows.

As the works have the potential for disturbance to and loss of habitats (notably grassland, trees, hedgerows and scrub) and species (e.g. badgers, otters, dormice, bats, red squirrels, Great crested newts, reptiles, birds and flora) during the construction works, mitigation measures will be implemented. These will include:

- felling trees and clearing vegetation outside of the bird breeding season where possible. Where this is not possible, ensuring an ecologist is present during any vegetation clearance, and at times chosen to minimise risk to bats (and also red squirrels and dormice on the Island);
- avoiding the root zones of adjacent trees to be retained;
- minimising the footprint of the works;
- selecting access routes and routes for stringing of the pipeline to avoid sensitive wildlife features; and
- erecting an noise/visual barrier to act as a screen for red squirrels and dormice present in the woodland area (Hornhill Copse) adjacent to the drill rig site at Gurnard.

Plans showing measures to protect affected trees have been prepared and will be adhered to in order to minimise the number of trees affected by the scheme. The proposals include planting of native trees to compensate for the felled trees and to provide landscaping for certain elements of the scheme. An aftercare management plan, documenting the proposed replanting and replacement of trees and hedgerows, will be implemented upon completion of the scheme. Where possible, new habitats will be created for invertebrates using surplus materials e.g. felled trees turned into log piles.

Further survey work for reptiles and Great crested newts is proposed in April 2010 to assess the impact of the scheme on these species. If present, appropriate mitigation will be implemented to ensure that

these species are not disturbed. An addendum to the ES will be prepared and submitted to DECC and MFA in Spring 2010 to present the results of these additional surveys.

Landscape and Visual Amenity

The entire study area on the Hampshire side lies within the New Forest National Park and part of the short stringing area at Gurnard will extend into the IoW AONB.

The presence of construction plant, heavy goods vehicles, personnel, stored materials and site compounds at both drill rig sites, along the pipe storage and stringing yard between Lepe and Langley, along the stringing area in the IoW AONB and in the footprint of the construction works will temporarily impact on the existing landscape character of the area. A tidy site policy will be employed by the contractor and the works will seek to maintain any existing natural screening around the site boundary, where possible. However, the felling of approximately 12 trees (and a small group of young trees) will be necessary during the construction works, which will be replanted on completion of the scheme.

During construction of the proposed scheme (notably the erection of drill-rig sites, stringing areas and the new PRS), there will be temporary changes of view for residents, vehicle travellers, pedestrians, and recreational users. The impact on these receptors will vary dependent on the location, existing view and establishment of vegetation on completion of the scheme.

At Gurnard, some residential properties on Rew Street opposite the entrance into the site (see Plate 3) will have a direct but partial view of the new PRS (Plate 4) on completion of the scheme.

The new PRS and associated infrastructure including low-level lighting will be located outside of the AONB and all buildings will be erected on the lower north-western part of the field to reduce their visibility from residential properties on Rew Street. The site will be landscaped with the planting of native trees and shrubs.



Plate 3: Existing landscape character at proposed rig and PRS site at Gurnard



Plate 4: Photomontage of Proposed PRS site at Gurnard i.e. indicative picture of what the PRS will look like approximately 5 - 10 years after completion of the scheme.

Land Use

There will be a temporary loss of moderate to good quality agricultural land for a temporary drill-rig site at Lepe, and temporary loss of agricultural land for compound and working areas at Lepe and Gurnard, and in the footprint of the pipe storage and stringing yard between Lepe and Langley (see Plates 1 to 3). Following reinstatement of all private and public areas affected by the construction works, there will be no significant residual impacts.

The works will also necessitate the permanent loss of 2000m² of poor quality agricultural land for the construction of a PRS and associated infrastructure at Gurnard. This will result in the reduced agricultural productivity of the land. The impacts on agriculture will be mitigated by retaining agricultural use of the remaining field and by compensating landowners for the loss of productivity.

Geology, Soils and Geomorphology

Approximately 800m³ of soil arisings will be disposed of in Hampshire, and 1300m³ of arisings on the Island. However, no impacts on geology, soils and geomorphology are anticipated as a result of constructing the scheme.

Noise and Vibration

It is inevitable that the level and nature of noise generated by construction activities will be greater than the pre-existing background noise levels and is therefore likely to cause disturbance and disruption to local residents. Disruption due to construction is generally localised and temporary in nature. Predictions indicate that noise levels generated by certain phases of the scheme have the potential to disturb residents and some recreational users during the construction works. Affected areas include Stone Farm, Lepe Country Park and residential properties adjacent to the stringing yard in the New Forest, and residential properties along Rew Street at Gurnard.

Several safeguards exist to minimise the effects of construction noise and these will operate during the works. Consent for certain noise generating activities (a Section 61 application) will be discussed with the local authorities and plant items will be properly maintained and operated to minimise noise disturbance. The local community will also be fully informed about the nature and timing of activities. A noise barrier will be temporarily erected around the drill rig site at Lepe and on the northern and eastern boundary of the drill rig site at Gurnard to minimise noise impacts.

If vibration is a nuisance to residents, and complaints arise, surveys will be undertaken to assess whether vibration is ground-borne or airborne and measures adopted to reduce vibration, if necessary.

Cultural and Archaeological Heritage

No designated sites of known archaeological interest will be affected by the footprint of the proposed works. Similarly, the installation of pipelines beneath the seabed will have no significant impacts on maritime archaeology. Any ground disturbance such as the removal of soils and shallow stripping and excavating works for open cut trenching and in the footprint of new infrastructure may disturb known (e.g. Neolithic and WWII finds at the drill-rig site at Lepe and post-medieval features extending southwards from Gurnard Farm) and unknown buried archaeological remains in the footprint of the proposed works. An archaeological watching brief will be provided during all excavation works. Any finds or features will be appropriately recorded and reported upon.

Traffic and Transport

There will be increased traffic flows on the local road network at Lepe and Gurnard during the construction works (notably during site set up, drilling and decommissioning), with the greatest impact on recreational users at Lepe Country Park and residents at Rew Street. The use of all roads leading to the site will require sensitivity to avoid disturbance to residents and other road users. At Gurnard, to minimise the disturbance to local residents in terms of inappropriate or unsafe parking, car parking facilities will be provided for site personnel at the drill rig site to prevent on-street parking occurring.

Temporary closure of Stanswood Road for testing of the pipes and a section of Cockleton Lane for pipeline installation will have a short-term impact on vehicle users. On the IoW, at the request of Gurnard residents, the open cut trenching in this area will be programmed outside of school holidays and access to Gurnard Pines holiday village will be maintained.

The Highways Authorities will continue to be consulted regarding access and diversion routes and timings of construction traffic to minimise the risk of disruption on the local road network.

There is potential for damage or spread of construction debris to local road access routes during construction. All vehicle access routes will be inspected following construction and any attributable damage to the works will be re-instated by the contractors. To prevent the spread of construction debris, a wheel wash will be provided for all heavy goods vehicles leaving the site at Gurnard, at Lepe the private concrete access road will be swept periodically, and any arisings that need to be transported off site will be in covered load carriers.

Human Beings

The proposed scheme will have a major benefit by maintaining a secure gas supply to those living, working and visiting the IoW. There will also be a small increase in labour associated with the construction works, which may have a minor beneficial effect on the local economy.

However, the proposed construction works lie adjacent to residential properties on Rew Street and Cockleton Lane in Gurnard and adjacent to Stone Farm and properties along the route of the stringing area at Lepe. During construction, there will be temporary elevated levels of noise, visual intrusion and disruption to access, which will cause disruption for local residents.

Two Public Rights of Ways will need to be temporally diverted at Lepe during construction. The temporary closure of the footpaths will be mitigated by providing a clearly signed diversion route agreed with Hampshire County Council and obtaining the necessary consents.

Information will be made available to local residents and the public in relation to the nature, timing and duration of particular construction activities and occupants and owners of affected properties will continue to be consulted over the construction programme.

Environmental Action Plan

An Environmental Action Plan (EAP) has been prepared and is a tool by which we manage the environmental impacts set out in the ES. The objectives, actions and targets set out in the EAP will be monitored throughout the detailed design, construction and post-construction stages of the project to ensure that the mitigation/compensation measures outlined in the ES are carried out.

ANNEX A: ENGINEERING DRAWINGS

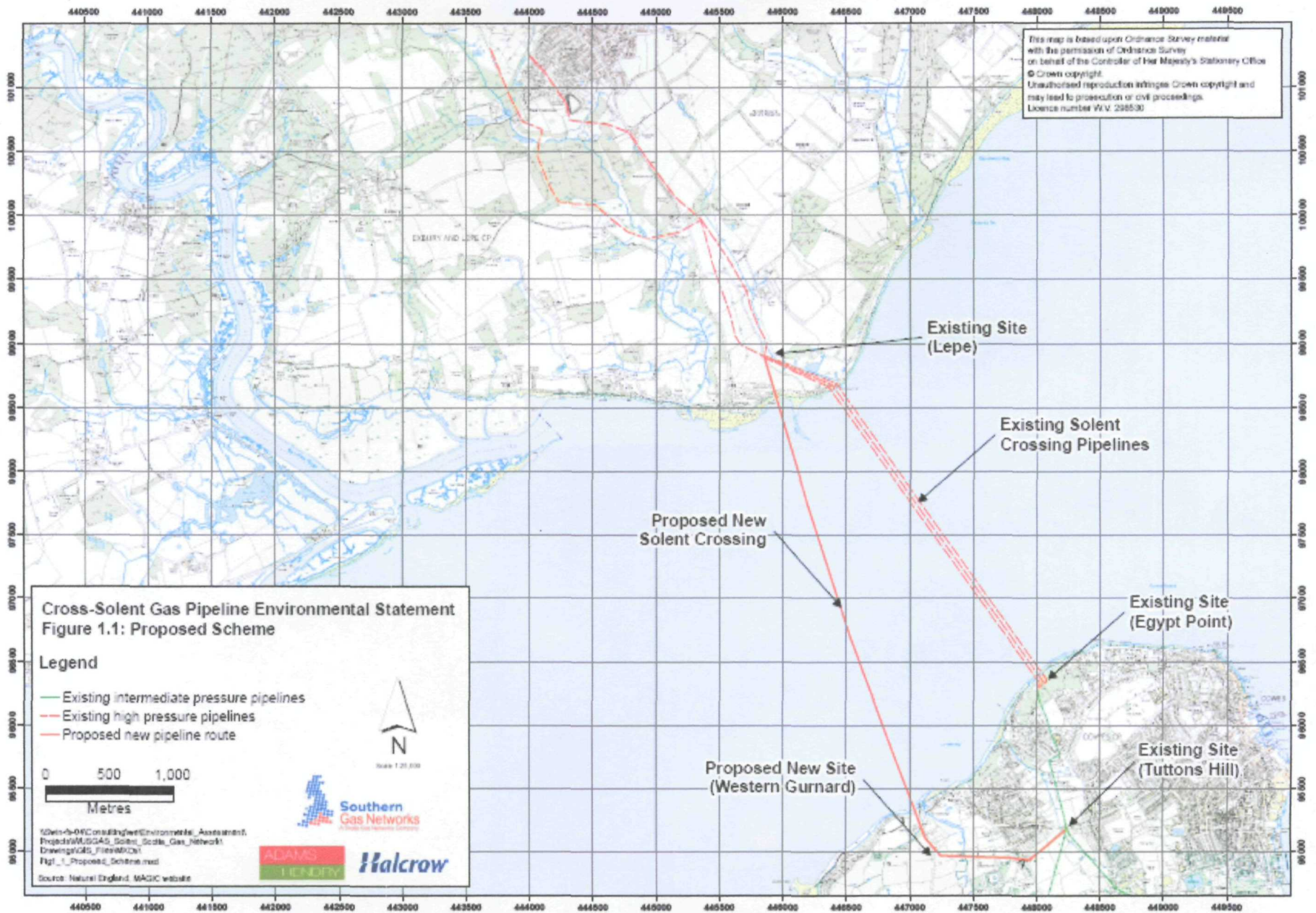

LEGEND:

	HDD/MARINE PIPELINE ROUTE
	LAND PIPELINE ROUTE
	OPEN CUT TRENCH
	LAND PIPELINE ROUTE
	HORIZ. DIRECTIONAL DRILL
	PROPOSED PIPELINE
	STRINGING OUT ROUTE
	EXISTING GAS MAINS
	PRS
	BOUNDARY OF TEMPORARY WORKING AREA

All levels are in metres relating to Ordnance Datum Meanly.



LOCATION PLAN
NTS

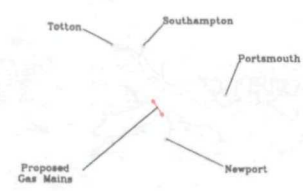

LOCATION OF SCHEME
NTS

REV	DESCRIPTION	Design	Drawn	Checked	Appr'd	Date
1	ISSUE FOR TENDERS	RUE	KDW	RUE	RUE	16/01/08
2	ISSUE FOR TENDERS	RUE	KDW	RUE	RUE	17/01/08
3	ISSUE FOR TENDERS	RUE	KDW	RUE	RUE	17/01/08
4	ISSUE FOR TENDERS	RUE	KDW	RUE	RUE	17/01/08
5	ISSUE FOR TENDERS	RUE	KDW	RUE	RUE	17/01/08
6	ISSUE FOR TENDERS	RUE	KDW	RUE	RUE	17/01/08
7	ISSUE FOR TENDERS	RUE	KDW	RUE	RUE	17/01/08
8	ISSUE FOR TENDERS	RUE	KDW	RUE	RUE	17/01/08
9	ISSUE FOR TENDERS	RUE	KDW	RUE	RUE	17/01/08
10	ISSUE FOR TENDERS	RUE	KDW	RUE	RUE	17/01/08
11	ISSUE FOR TENDERS	RUE	KDW	RUE	RUE	17/01/08
12	ISSUE FOR TENDERS	RUE	KDW	RUE	RUE	17/01/08
13	ISSUE FOR TENDERS	RUE	KDW	RUE	RUE	17/01/08
14	ISSUE FOR TENDERS	RUE	KDW	RUE	RUE	17/01/08
15	ISSUE FOR TENDERS	RUE	KDW	RUE	RUE	17/01/08
16	ISSUE FOR TENDERS	RUE	KDW	RUE	RUE	17/01/08
17	ISSUE FOR TENDERS	RUE	KDW	RUE	RUE	17/01/08
18	ISSUE FOR TENDERS	RUE	KDW	RUE	RUE	17/01/08
19	ISSUE FOR TENDERS	RUE	KDW	RUE	RUE	17/01/08
20	ISSUE FOR TENDERS	RUE	KDW	RUE	RUE	17/01/08
21	ISSUE FOR TENDERS	RUE	KDW	RUE	RUE	17/01/08
22	ISSUE FOR TENDERS	RUE	KDW	RUE	RUE	17/01/08
23	ISSUE FOR TENDERS	RUE	KDW	RUE	RUE	17/01/08
24	ISSUE FOR TENDERS	RUE	KDW	RUE	RUE	17/01/08
25	ISSUE FOR TENDERS	RUE	KDW	RUE	RUE	17/01/08
26	ISSUE FOR TENDERS	RUE	KDW	RUE	RUE	17/01/08
27	ISSUE FOR TENDERS	RUE	KDW	RUE	RUE	17/01/08
28	ISSUE FOR TENDERS	RUE	KDW	RUE	RUE	17/01/08
29	ISSUE FOR TENDERS	RUE	KDW	RUE	RUE	17/01/08
30	ISSUE FOR TENDERS	RUE	KDW	RUE	RUE	17/01/08
31	ISSUE FOR TENDERS	RUE	KDW	RUE	RUE	17/01/08
32	ISSUE FOR TENDERS	RUE	KDW	RUE	RUE	17/01/08
33	ISSUE FOR TENDERS	RUE	KDW	RUE	RUE	17/01/08
34	ISSUE FOR TENDERS	RUE	KDW	RUE	RUE	17/01/08
35	ISSUE FOR TENDERS	RUE	KDW	RUE	RUE	17/01/08
36	ISSUE FOR TENDERS	RUE	KDW	RUE	RUE	17/01/08
37	ISSUE FOR TENDERS	RUE	KDW	RUE	RUE	17/01/08
38	ISSUE FOR TENDERS	RUE	KDW	RUE	RUE	17/01/08
39	ISSUE FOR TENDERS	RUE	KDW	RUE	RUE	17/01/08
40	ISSUE FOR TENDERS	RUE	KDW	RUE	RUE	17/01/08
41	ISSUE FOR TENDERS	RUE	KDW	RUE	RUE	17/01/08
42	ISSUE FOR TENDERS	RUE	KDW	RUE	RUE	17/01/08
43	ISSUE FOR TENDERS	RUE	KDW	RUE	RUE	17/01/08
44	ISSUE FOR TENDERS	RUE	KDW	RUE	RUE	17/01/08
45	ISSUE FOR TENDERS	RUE	KDW	RUE	RUE	17/01/08
46	ISSUE FOR TENDERS	RUE	KDW	RUE	RUE	17/01/08
47	ISSUE FOR TENDERS	RUE	KDW	RUE	RUE	17/01/08
48	ISSUE FOR TENDERS	RUE	KDW	RUE	RUE	17/01/08
49	ISSUE FOR TENDERS	RUE	KDW	RUE	RUE	17/01/08
50	ISSUE FOR TENDERS	RUE	KDW	RUE	RUE	17/01/08



Project No. CROSS SOLENT GAS MAIN REPLACEMENT SCHEME

Sheet No. HDD WORKS GENERAL PLAN

Drawn AS SHOWN	Drawn by KDW	Date drawn	Drawn on
Checked by RUE	Checked by RUE	Date checked	25/01/08
Approved by RUE	Approved by RUE	Date approved	
Drawing No. WUSGAS 2001	Revision	1	

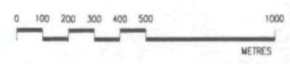
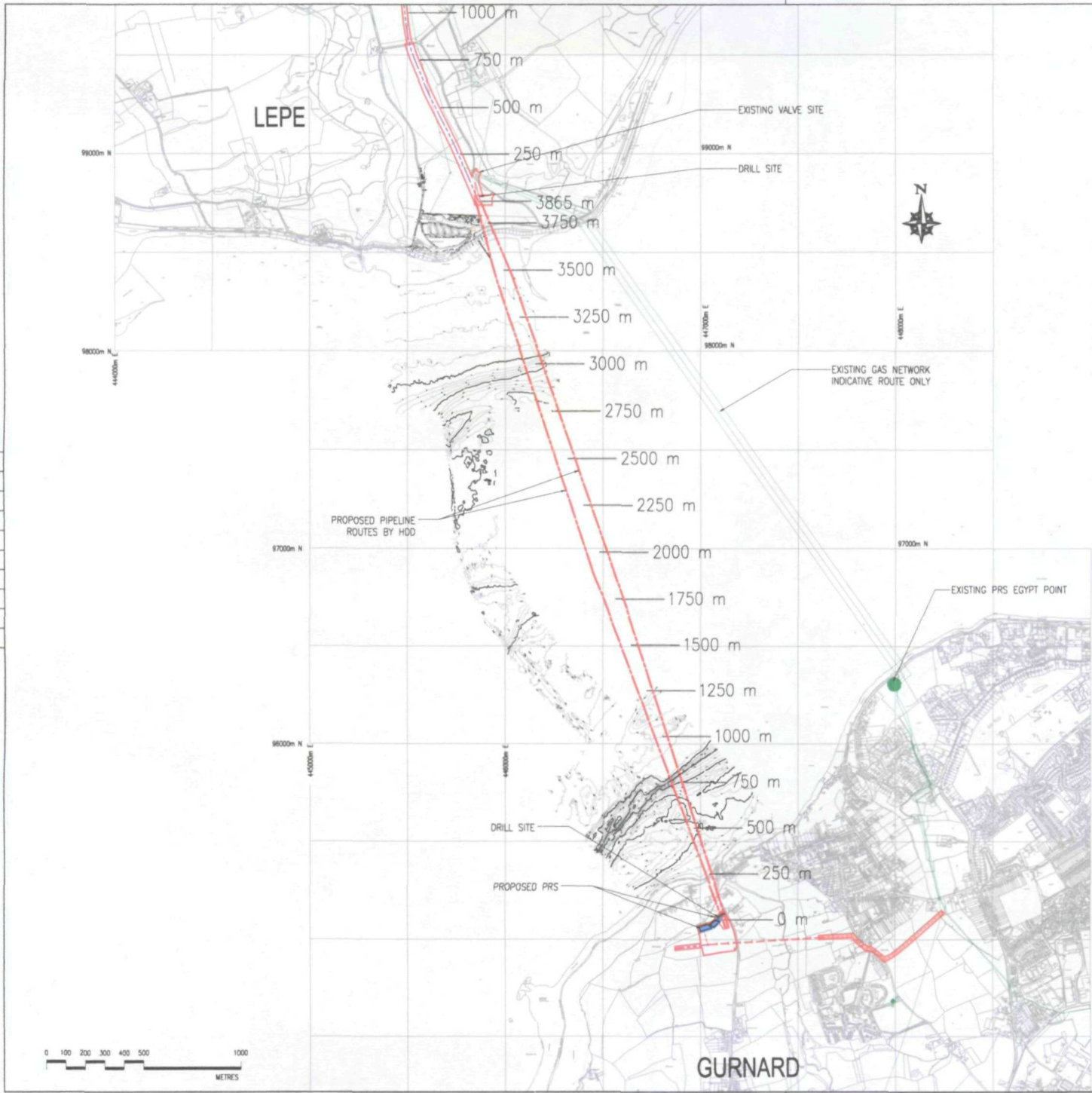

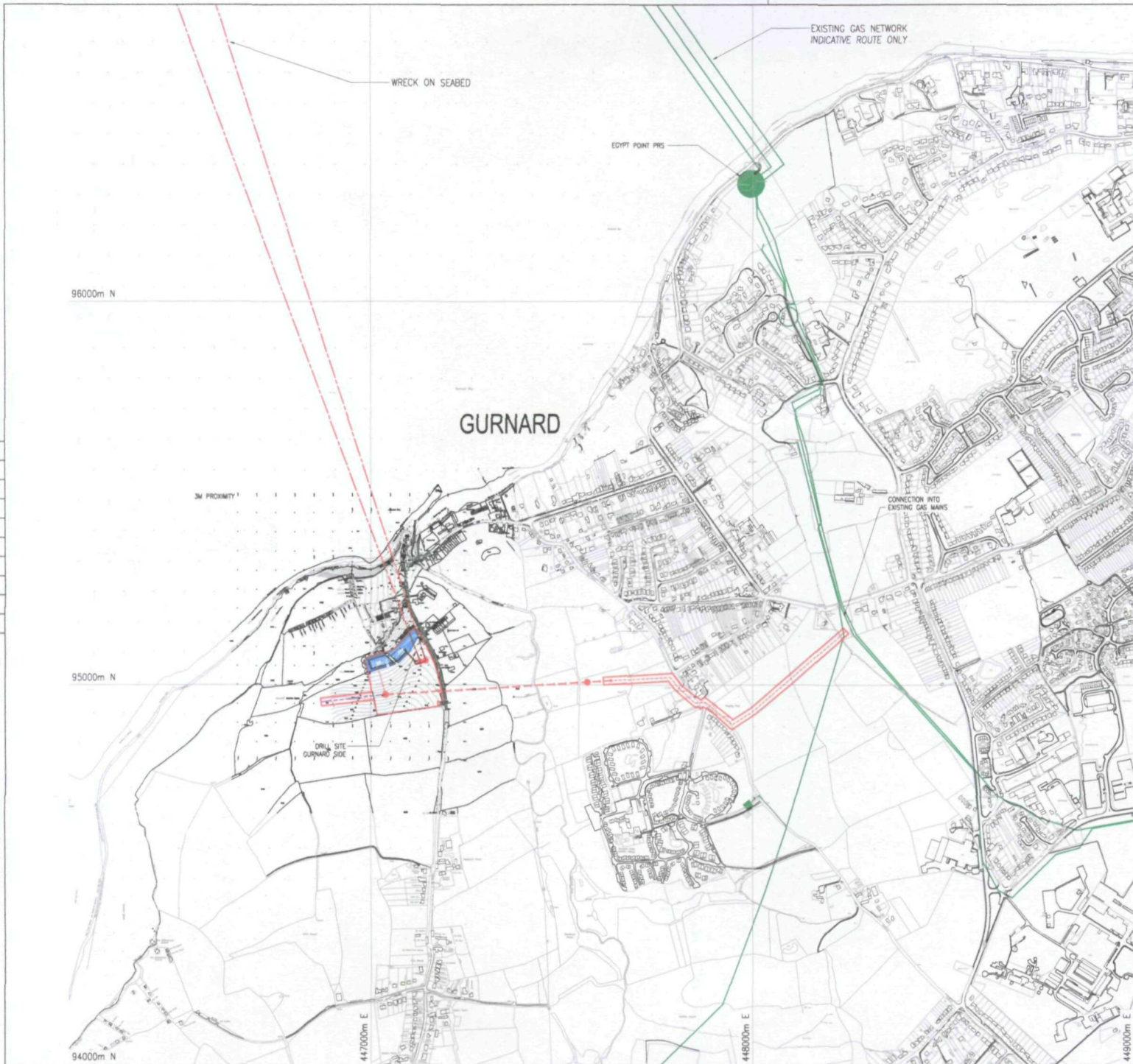

Drawing No: WUSGAS 2008 Revision: H

- LEGEND:**
- PROPOSED ROUTE**
- HDD/MARINE PIPELINE ROUTE
 - LAND PIPELINE ROUTE
 - OPEN CUT TRENCH
 - LAND PIPELINE ROUTE
 - HORIZ' DIRECTIONAL DRILL
 - PROPOSED PIPELINE STRINGING OUT ROUTE
 - EXISTING GAS MAINS
- PHS
- BOUNDARY OF TEMPORARY WORKING AREA
- APPROXIMATE DRILL ENTRY / EXIT LOCATIONS

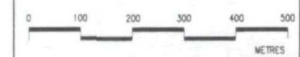
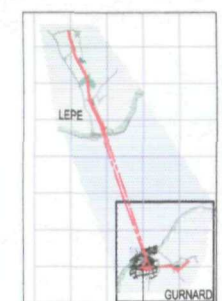

4 PHS AMENDMENT	RUE	DAH	RUE	RUE	21/01/08
5 CORNER AMENDMENTS	RUE	DAH	RUE	RUE	21/01/08
7 TWIN PIPE CROSSING	RUE	DAH	RUE	RUE	21/01/08
8 TRENCH AMENDMENTS	RUE	CLS	RUE	RUE	14/07/08
9 PHS LOCATION AMENDMENT	SDC	LDP	RUE	RUE	27/02/08
10 SPRINGING DELETED	RUE	LDP	RUE	RUE	27/02/08
11 FIRST ISSUE	RUE	LDP	RUE	RUE	08/04/08
12 PRELIMINARY	RUE	KOW	RUE	RUE	25/01/08

REV DESCRIPTION Design Drawn Checked Approval Date

Copyright and other intellectual property rights in this document and all related documents are the intellectual property of Southern Gas Networks. Where they have been created without the express permission or writing of Southern Gas Networks.



Project title: CROSS SOLENT GAS MAIN REPLACEMENT SCHEME

Drawing title: HDD WORKS GURNARD PLAN

Drawn by: AS SHOWN	Drawn by: KOW	Date issued:	Drawn date:
Checked by: RJE	Checked by: RJE	Approved by: RJE	Date issued: 25/01/08
Drawing No: WUSGAS 2008	Revision: H		



Drawing No. WUSGAS 2009		Sheet No. H																																																	
LEGEND:																																																			
---	HDD/MARINE PIPELINE ROUTE	---	LOCATIONS																																																
---	LAND PIPELINE ROUTE	---	APPROXIMATE DRILL ENTRY / EXIT LOCATIONS																																																
---	CREW CUT TRENCH	---	UNDERGROUND HV ELECTRIC CABLE																																																
---	LAND PIPELINE ROUTE	---	UNDERGROUND FIBRE OPTIC TELECOM CABLE																																																
---	HORIZ' DIRECTIONAL DRILL	---	EXISTING WATER MAIN (INDICATIVE ROUTING TO BE VERIFIED)																																																
---	PROPOSED PIPELINE STRINGING OUT ROUTE																																																		
---	PPS																																																		
---	BOUNDARY OF TEMPORARY WORKING AREA																																																		
---	APPROXIMATE DRILL ENTRY / EXIT LOCATIONS																																																		
---	UNDERGROUND HV ELECTRIC CABLE																																																		
---	UNDERGROUND FIBRE OPTIC TELECOM CABLE																																																		
---	EXISTING WATER MAIN (INDICATIVE ROUTING TO BE VERIFIED)																																																		
<table border="1"> <tr> <td>H PPS AMENDED</td> <td>RJR</td> <td>DRH</td> <td>IRE</td> <td>RJE</td> <td>21/02/09</td> </tr> <tr> <td>G MINOR AMENDMENTS</td> <td>RJR</td> <td>DRH</td> <td>IRB</td> <td>RJE</td> <td>03/03/09</td> </tr> <tr> <td>F TWIN PIPE CROSSINGS</td> <td>RJR</td> <td>DRH</td> <td>IRB</td> <td>RJE</td> <td>07/03/09</td> </tr> <tr> <td>G MAJOR AMENDMENTS</td> <td>KG</td> <td>RSJ</td> <td>IRB</td> <td>RJE</td> <td>16/02/09</td> </tr> <tr> <td>D PPS LOCATION AMENDED</td> <td>KG</td> <td>ECP</td> <td>IRB</td> <td>RJE</td> <td>07/02/09</td> </tr> <tr> <td>C D5 GASPILES ADDED</td> <td>KG</td> <td>WMC</td> <td>IRB</td> <td>RJE</td> <td>18/02/09</td> </tr> <tr> <td>F1 TEST PILE</td> <td>KG</td> <td>CCP</td> <td>IRB</td> <td>RJE</td> <td>06/02/09</td> </tr> <tr> <td>A PRELIMINARY</td> <td>KG</td> <td>PDW</td> <td>IRB</td> <td>RJE</td> <td>07/02/09</td> </tr> </table>				H PPS AMENDED	RJR	DRH	IRE	RJE	21/02/09	G MINOR AMENDMENTS	RJR	DRH	IRB	RJE	03/03/09	F TWIN PIPE CROSSINGS	RJR	DRH	IRB	RJE	07/03/09	G MAJOR AMENDMENTS	KG	RSJ	IRB	RJE	16/02/09	D PPS LOCATION AMENDED	KG	ECP	IRB	RJE	07/02/09	C D5 GASPILES ADDED	KG	WMC	IRB	RJE	18/02/09	F1 TEST PILE	KG	CCP	IRB	RJE	06/02/09	A PRELIMINARY	KG	PDW	IRB	RJE	07/02/09
H PPS AMENDED	RJR	DRH	IRE	RJE	21/02/09																																														
G MINOR AMENDMENTS	RJR	DRH	IRB	RJE	03/03/09																																														
F TWIN PIPE CROSSINGS	RJR	DRH	IRB	RJE	07/03/09																																														
G MAJOR AMENDMENTS	KG	RSJ	IRB	RJE	16/02/09																																														
D PPS LOCATION AMENDED	KG	ECP	IRB	RJE	07/02/09																																														
C D5 GASPILES ADDED	KG	WMC	IRB	RJE	18/02/09																																														
F1 TEST PILE	KG	CCP	IRB	RJE	06/02/09																																														
A PRELIMINARY	KG	PDW	IRB	RJE	07/02/09																																														
<p>REVISIONS: Design Team, Checked Approval Date</p> <p>This report and other intellectual property rights in this document shall be deemed to constitute a design, etc., including applications, in respect of Southern Gas Networks Limited and shall be treated as such for all purposes other than for which they have been created without the express permission in writing by Southern Gas Networks Limited.</p>																																																			
<p>Southern Gas Networks A Gas Supply Networks Company</p>																																																			
<p>Malcrow</p>																																																			
<p>Project No. CROSS SOLENT GAS MAIN REPLACEMENT SCHEME</p>																																																			
<p>Drawing No. HDD WORKS GURNARD SITE PLAN</p>																																																			
<table border="1"> <tr> <td>Scale AS SHOWN</td> <td>Drawn by KDW</td> <td>Dist. scale</td> <td>Sheet No.</td> </tr> <tr> <td>Project No. WUSGAS 2009</td> <td>Checked by RJE</td> <td>Approved by RJE</td> <td>Date issued 27/05/08</td> </tr> <tr> <td>Drawing No. WUSGAS 2009</td> <td></td> <td></td> <td></td> </tr> </table>				Scale AS SHOWN	Drawn by KDW	Dist. scale	Sheet No.	Project No. WUSGAS 2009	Checked by RJE	Approved by RJE	Date issued 27/05/08	Drawing No. WUSGAS 2009																																							
Scale AS SHOWN	Drawn by KDW	Dist. scale	Sheet No.																																																
Project No. WUSGAS 2009	Checked by RJE	Approved by RJE	Date issued 27/05/08																																																
Drawing No. WUSGAS 2009																																																			

LEGEND

	PROPOSED ROUTE		HDD/MARNE PIPELINE ROUTE
	LAND PIPELINE ROUTE		OPEN CUT TRENCH
	PROPOSED PIPELINE STRINGING OUT ROUTE		EXISTING GAS MAINS
	OVERHEAD HV CABLE		BOUNDARY OF TEMPORARY WORKING AREA

All levels are in metres relating to Ordnance Datum Newlyn

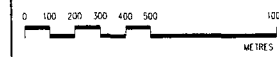
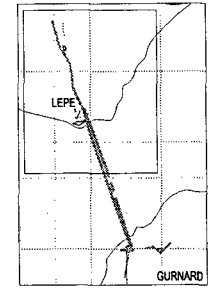

E	MINOR AMENDMENTS	RJE	DLH	RJE	RJE	15/10/09
D	MAIN PIPE CROSSING	RJE	DLH	RJE	RJE	16/10/09
C	MINOR AMENDMENTS	RJE	DLH	RJE	RJE	16/10/09
B	FINAL DESIGN	RJE	DLH	RJE	RJE	16/10/09
A	PRELIMINARY	RJE	DLH	RJE	RJE	16/10/09

REVISIONS: Design | Draw | Check | Appro | Date



Project No: CROSS SOLENT GAS MAIN REPLACEMENT SCHEME

Drawing No: HDD WORKS LEPE PIPE STRINGING PLAN

Scale: AS SHOWN	Drawn by: YDW	Date of issue:	Sheet size:
Authorised by: YJC	Checked by: RJE	Issued by: RJE	Date approved: 25/01/08

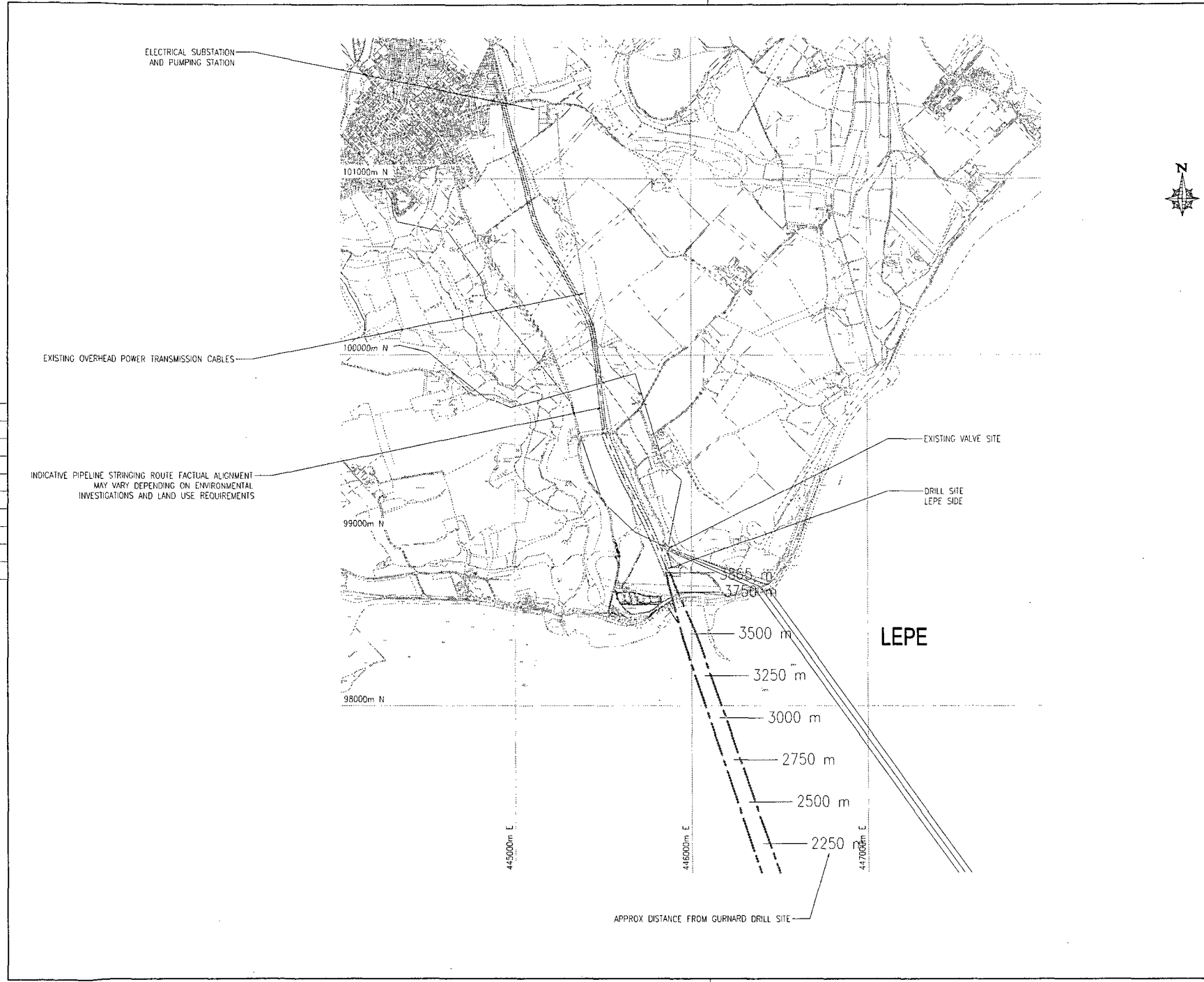

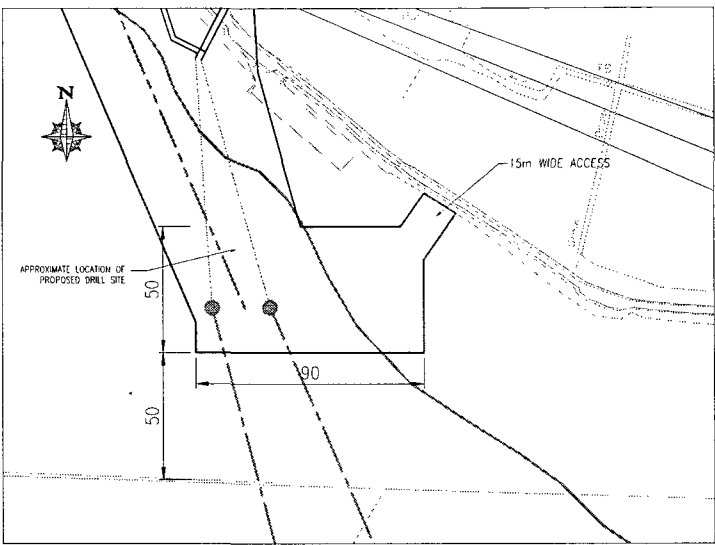
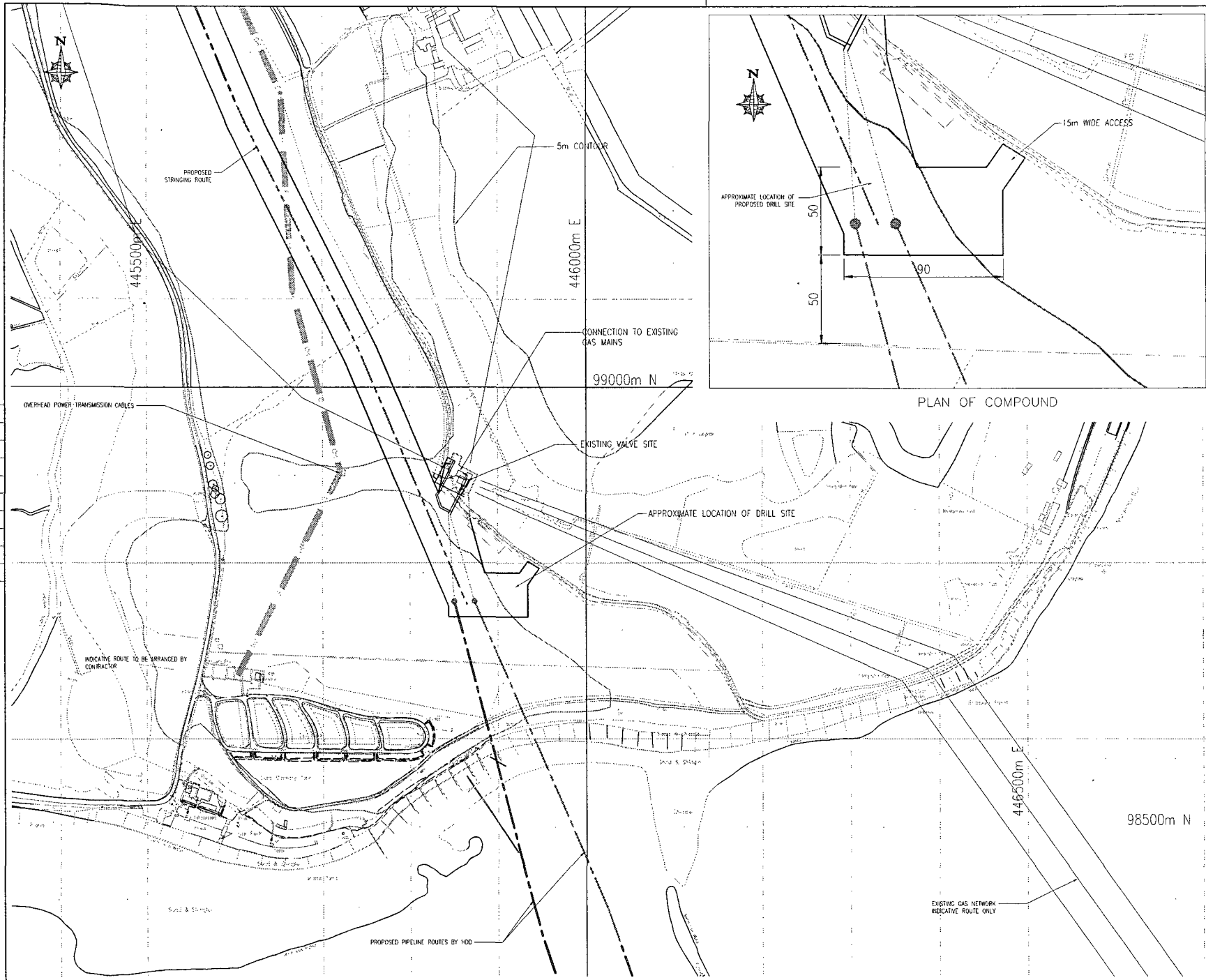

WUSGAS 2006		G																																																	
<p>LEGEND:</p> <p>PROPOSED ROUTE</p> <ul style="list-style-type: none"> --- HDD/MARINE PIPELINE ROUTE --- LAND PIPELINE ROUTE --- PROPOSED PIPELINE STRINGING OUT ROUTE --- EXISTING GAS MAINS --- BOUNDARY OF TEMPORARY WORKING AREA ● APPROXIMATE DRILL ENTRY / EXIT LOCATIONS <p>All levels are in metres relating to Ordnance Datum Newlyn</p>																																																			
<table border="1"> <tr> <td>C VALVE STATION AMEND</td> <td>RJE</td> <td>KDW</td> <td>RJE</td> <td>RJE</td> <td>12/02/08</td> </tr> <tr> <td>F MAJOR AMENDMENTS</td> <td>RJE</td> <td>KDW</td> <td>RJE</td> <td>RJE</td> <td>12/02/08</td> </tr> <tr> <td>E TWIN PIPE CROSSING</td> <td>RJE</td> <td>KDW</td> <td>RJE</td> <td>RJE</td> <td>02/02/08</td> </tr> <tr> <td>D MAJOR AMENDMENTS</td> <td>BM</td> <td>GLS</td> <td>RJE</td> <td>RJE</td> <td>01/02/08</td> </tr> <tr> <td>C LOS CHANGES ADDED</td> <td>BM</td> <td>WMC</td> <td>RJE</td> <td>RJE</td> <td>16/09/08</td> </tr> <tr> <td>B FIRST ISSUE</td> <td>BM</td> <td>KLP</td> <td>RJE</td> <td>RJE</td> <td>09/02/08</td> </tr> <tr> <td>A PRELIMINARY</td> <td>BM</td> <td>KDW</td> <td>RJE</td> <td>RJE</td> <td>03/02/08</td> </tr> <tr> <td>REVISED/ISSUED</td> <td>Design</td> <td>Drawn</td> <td>Checked</td> <td>Approved</td> <td>Date</td> </tr> </table> <p><small>Copyright and other material are the property of Southern Gas Networks. All rights reserved. No part of this document may be reproduced, stored in a retrieval system, or transmitted in any form or by any means, electronic, mechanical, photocopying, recording, or by any information storage and retrieval system, without the prior written permission of Southern Gas Networks.</small></p>				C VALVE STATION AMEND	RJE	KDW	RJE	RJE	12/02/08	F MAJOR AMENDMENTS	RJE	KDW	RJE	RJE	12/02/08	E TWIN PIPE CROSSING	RJE	KDW	RJE	RJE	02/02/08	D MAJOR AMENDMENTS	BM	GLS	RJE	RJE	01/02/08	C LOS CHANGES ADDED	BM	WMC	RJE	RJE	16/09/08	B FIRST ISSUE	BM	KLP	RJE	RJE	09/02/08	A PRELIMINARY	BM	KDW	RJE	RJE	03/02/08	REVISED/ISSUED	Design	Drawn	Checked	Approved	Date
C VALVE STATION AMEND	RJE	KDW	RJE	RJE	12/02/08																																														
F MAJOR AMENDMENTS	RJE	KDW	RJE	RJE	12/02/08																																														
E TWIN PIPE CROSSING	RJE	KDW	RJE	RJE	02/02/08																																														
D MAJOR AMENDMENTS	BM	GLS	RJE	RJE	01/02/08																																														
C LOS CHANGES ADDED	BM	WMC	RJE	RJE	16/09/08																																														
B FIRST ISSUE	BM	KLP	RJE	RJE	09/02/08																																														
A PRELIMINARY	BM	KDW	RJE	RJE	03/02/08																																														
REVISED/ISSUED	Design	Drawn	Checked	Approved	Date																																														
<p>Project Title: CROSS SOLENT GAS MAIN REPLACEMENT SCHEME</p>																																																			
<p>Drawing Title: HDD WORKS SITE PLAN LEPE</p>																																																			
<table border="1"> <tr> <td>Scale: AS SHOWN</td> <td>Drawn by: KDW</td> <td>Date drawn: 12/02/08</td> <td>Drawn by: RJE</td> </tr> <tr> <td>Checked by: RJE</td> <td>Checked by: RJE</td> <td>Checked by: RJE</td> <td>Checked by: RJE</td> </tr> </table>				Scale: AS SHOWN	Drawn by: KDW	Date drawn: 12/02/08	Drawn by: RJE	Checked by: RJE	Checked by: RJE	Checked by: RJE	Checked by: RJE																																								
Scale: AS SHOWN	Drawn by: KDW	Date drawn: 12/02/08	Drawn by: RJE																																																
Checked by: RJE	Checked by: RJE	Checked by: RJE	Checked by: RJE																																																
WUSGAS 2006		G																																																	

LEGEND

- PLANNING APPLICATION AREA
- PERMANENT INSTALLATION
- TREES TO BE RETAINED



REPRODUCED FROM ORDNANCE SURVEY
MAPPING WITH THE SANCTION OF THE
CONTROLLER OF HM STATIONARY OFFICE
CROWN COPYRIGHT RESERVED

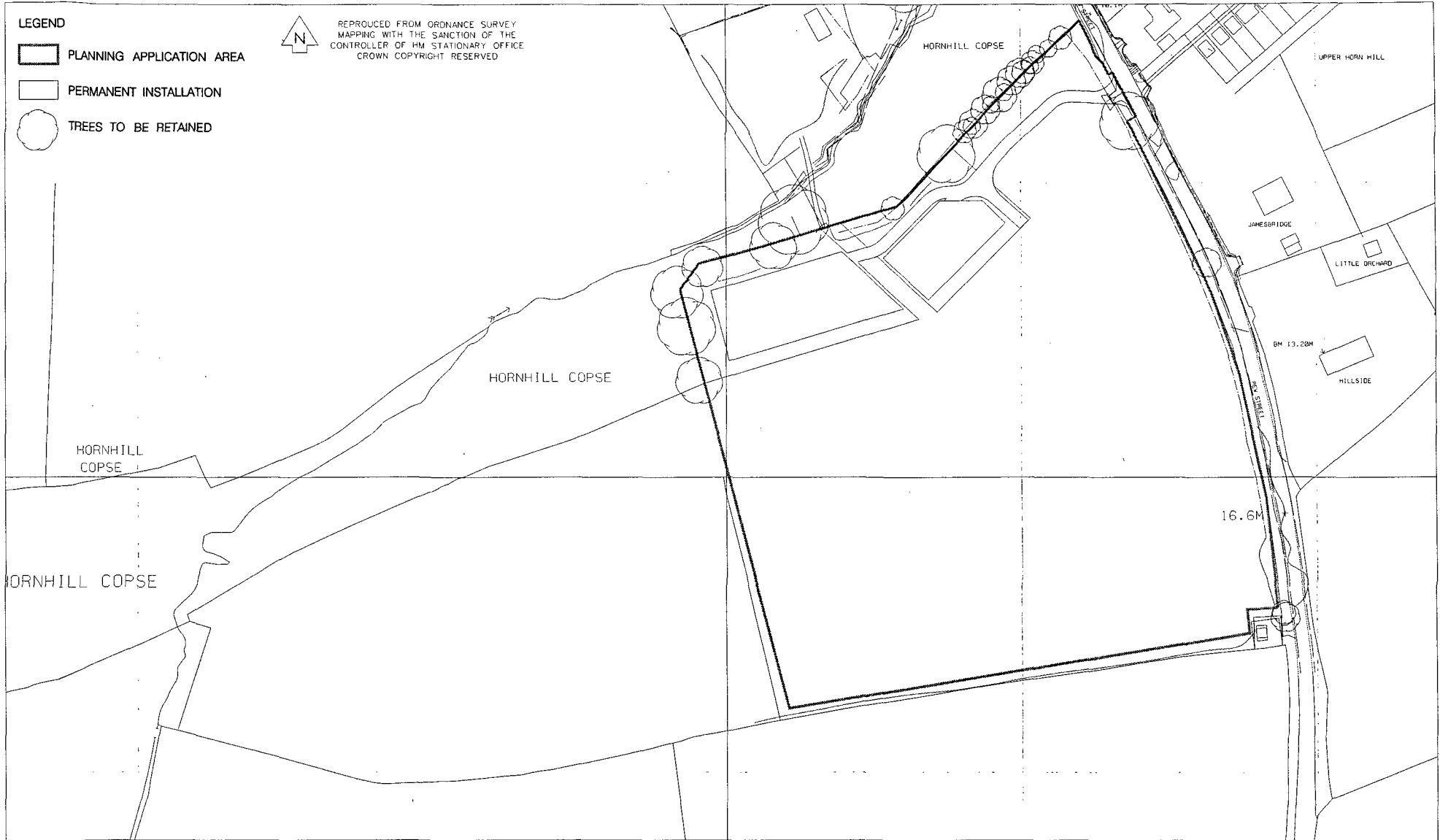







REV	DATE	DRWN	DESCRIPTION	CHK'D	APP'D
A	22/01/10	GH	ISSUED FOR INFORMATION		

SITE / PROJECT
SOLENT TRANSITS
TITLE
PLANNING APPLICATION BOUNDARY

DATE 18/01/10	DR'WN GH	CHK'D	APPR'D
SCALE 1 : 1250	A3	© Copyright of Scotia Gas Networks Ltd	
EXTERNAL REFERENCE			REV.
DRAWING No. C69882/L/005			REV. A



LEGEND

-  PLANNING APPLICATION BOUNDARY
-  PERMANENT INSTALLATION
-  TEMPORARY WORKING AREA AGI & PIPELINE CONSTRUCTION
-  IP PIPELINE HDD PIPE STRING AREA ONLY
-  AGI ACCESS
-  TEMPORARY ACCESS



REPRODUCED FROM ORDNANCE SURVEY
MAPPING WITH THE SANCTION OF THE
CONTROLLER OF HM STATIONARY OFFICE
CROWN COPYRIGHT RESERVED

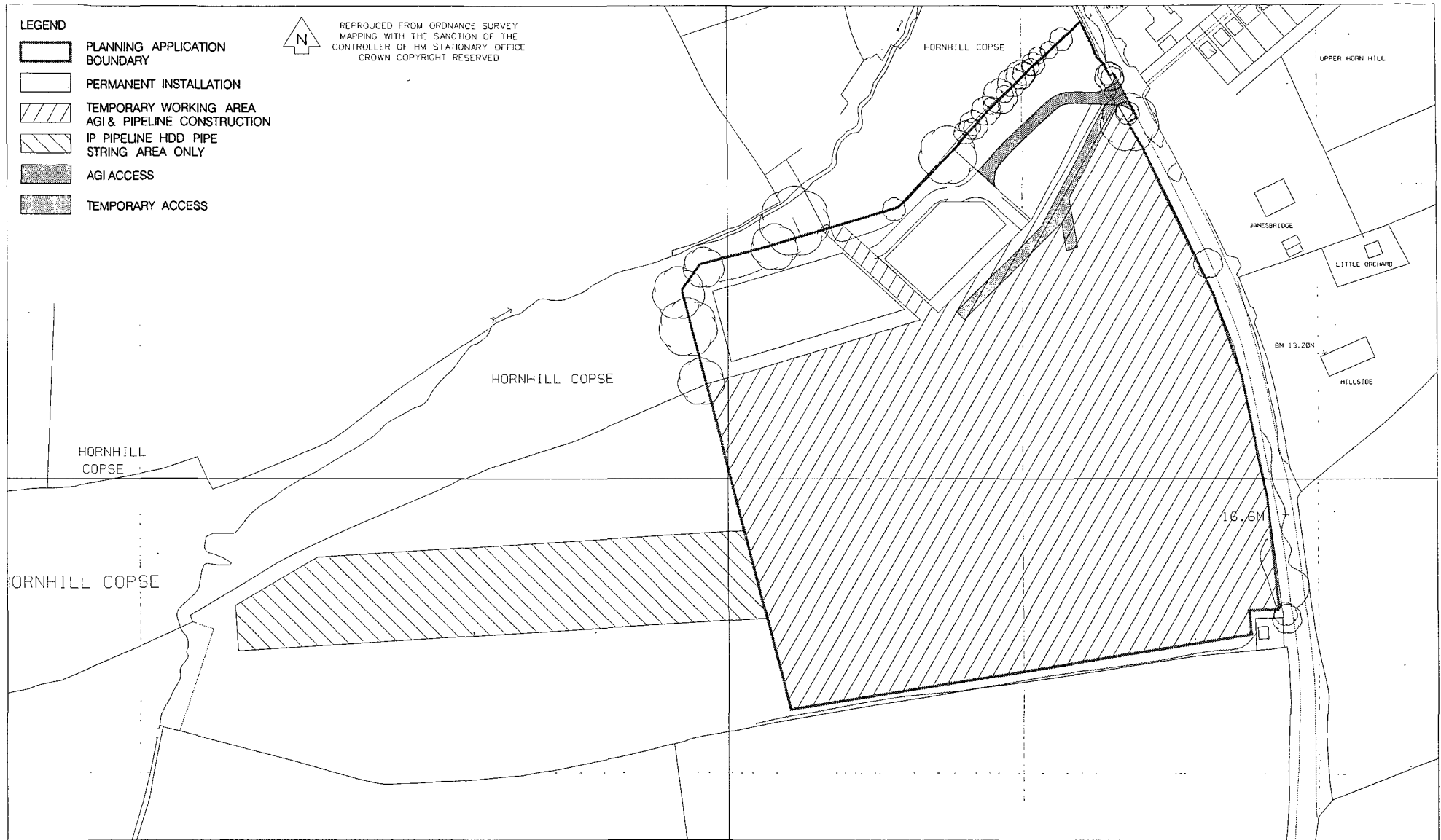

REV	DATE	DR'WN	DESCRIPTION	CHK'D	APP'D
B	19/02/10	GH	LEGEND DETAIL AMENDED ISSUED FOR INFORMATION		
A	22/01/10	GH			

SITE / PROJECT	SOLENT PIPELINE
TITLE	PLANNING APPLICATION PIPELINE & AGI WORKING AREAS

DATE	22/01/10	DR'WN	GH	CHK'D	APPR'D
SCALE	1 : 1250	A3	© Copyright of Scotia Gas Networks Ltd		
EXTERNAL REFERENCE					REV.
DRAWING No.	C69882/L/006				REV. B



0 10 20 30 40 50

SCALE - METRES



FOR PROFILE SECTIONS LINES
SEE DRAWING C69882/L/002
SHEETS 1 & 2

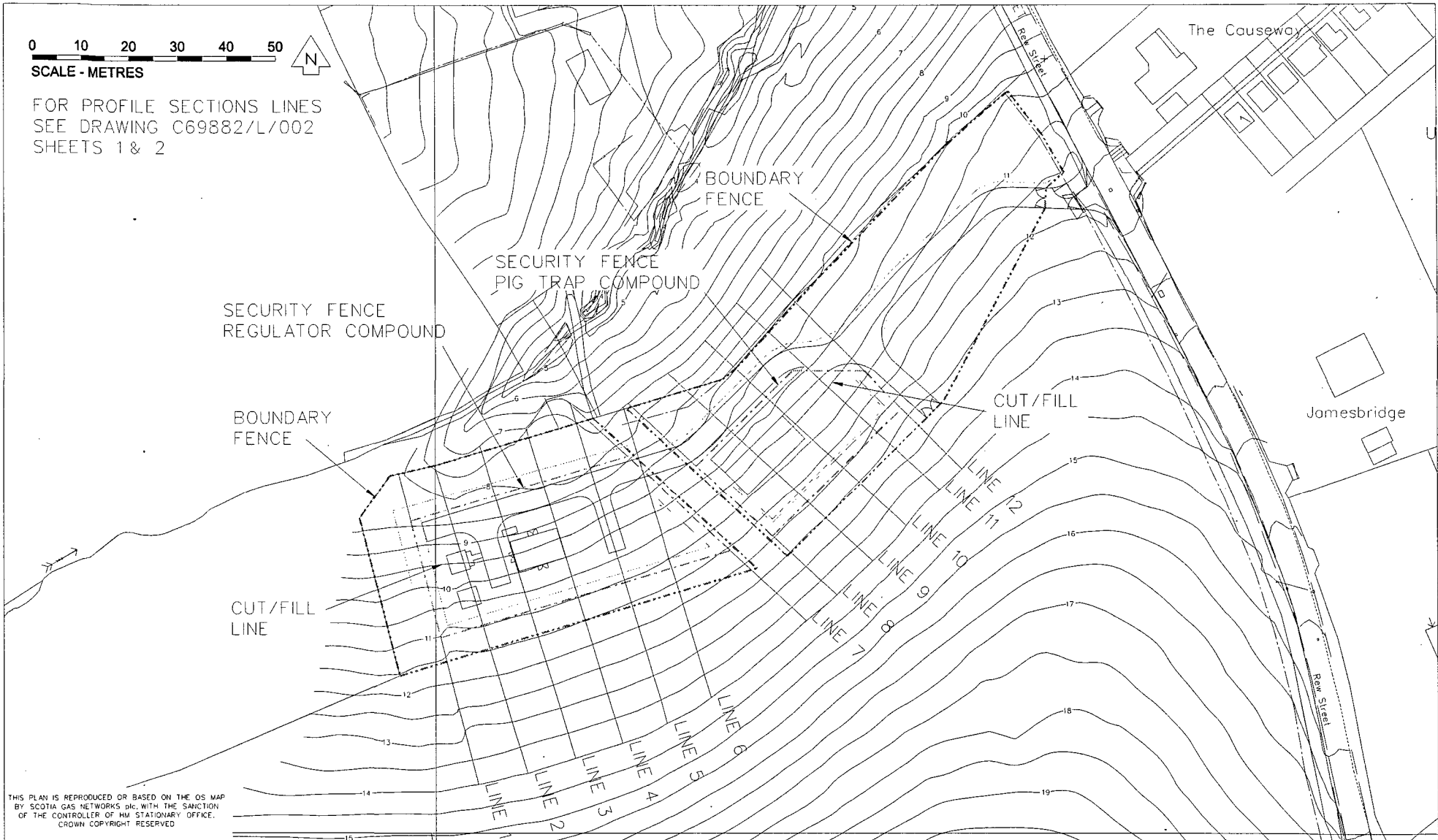

THIS PLAN IS REPRODUCED OR BASED ON THE OS MAP
BY SCOTIA GAS NETWORKS plc, WITH THE SANCTION
OF THE CONTROLLER OF HM STATIONARY OFFICE.
CROWN COPYRIGHT RESERVED

REV	DATE	DRWN	DESCRIPTION	CHK'D	APP'D
C	190210	GH	DRAWING BORDER UPDATE		
B	150210	GH	SITE DETAILS UPDATED ISSUED FOR INFORMATION		
A	241209	GH	ISSUED FOR INFORMATION		

SITE / PROJECT	SOLENT TRANSIT PIPELINE PROJECT
TITLE	GURNARD AGI PRELIMINARY SITE PROFILES SITE PLAN

DATE 24/12/09	DR'WN GH	CHK'D	APPR'D
SCALE 1:750	A3	© Copyright of Scotia Gas Networks Ltd	
EXTERNAL REFERENCE			REV.
DRAWING No. C69882/L/001			REV. C



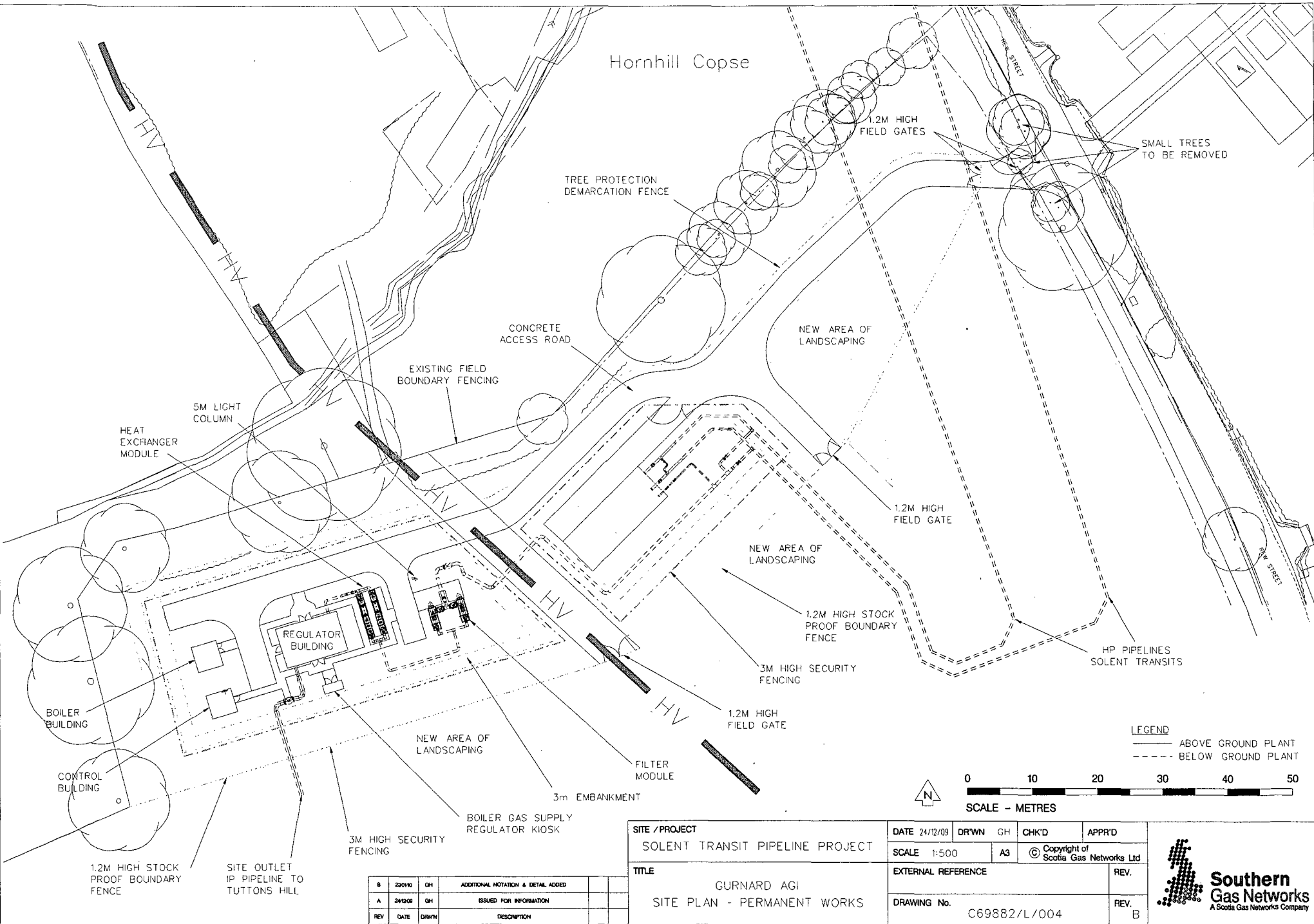

Hornhill Copse

SMALL TREES TO BE REMOVED

TREE PROTECTION DEMARCATION FENCE

CONCRETE ACCESS ROAD

NEW AREA OF LANDSCAPING

EXISTING FIELD BOUNDARY FENCING

5M LIGHT COLUMN

HEAT EXCHANGER MODULE

1.2M HIGH FIELD GATE

NEW AREA OF LANDSCAPING

1.2M HIGH STOCK PROOF BOUNDARY FENCE

3M HIGH SECURITY FENCING

HP PIPELINES SOLENT TRANSITS

REGULATOR BUILDING

BOILER BUILDING

CONTROL BUILDING

NEW AREA OF LANDSCAPING

FILTER MODULE

1.2M HIGH FIELD GATE

3m EMBANKMENT

BOILER GAS SUPPLY REGULATOR KIOSK

3M HIGH SECURITY FENCING

1.2M HIGH STOCK PROOF BOUNDARY FENCE

SITE OUTLET IP PIPELINE TO TUTTONS HILL

LEGEND
 ——— ABOVE GROUND PLANT
 - - - - - BELOW GROUND PLANT



REV	DATE	DRAWN	DESCRIPTION
B	22/01/10	GH	ADDITIONAL NOTATION & DETAIL ADDED
A	24/12/09	GH	ISSUED FOR INFORMATION

SITE / PROJECT SOLENT TRANSIT PIPELINE PROJECT		DATE 24/12/09	DR'WN GH	CHK'D	APPR'D
TITLE GURNARD AGI SITE PLAN - PERMANENT WORKS		SCALE 1:500	A3	© Copyright of Scotia Gas Networks Ltd	
EXTERNAL REFERENCE		DRAWING No.		REV. B	
		C69882/L/004			



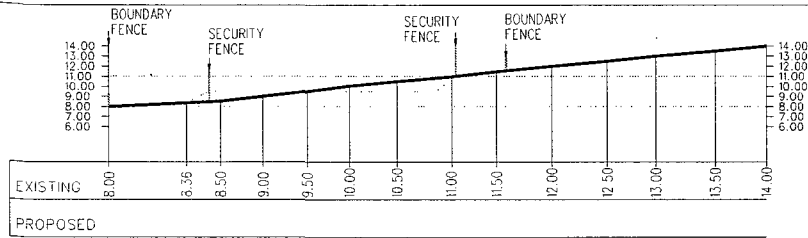

LINE 1
REGULATOR
WEST SECURITY FENCE

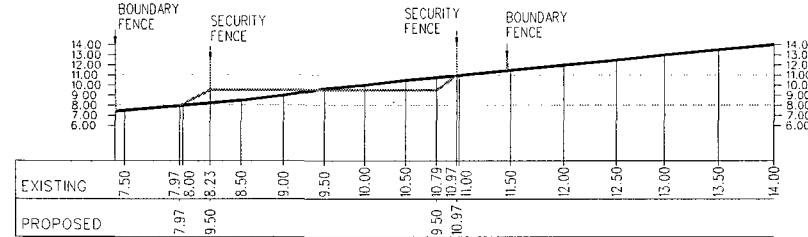

LINE 2
REGULATOR COMPOUND

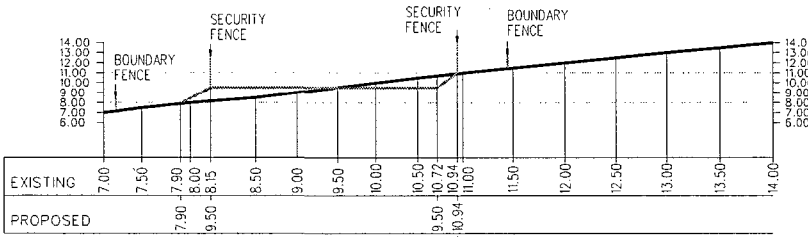

LINE 3
REGULATOR COMPOUND

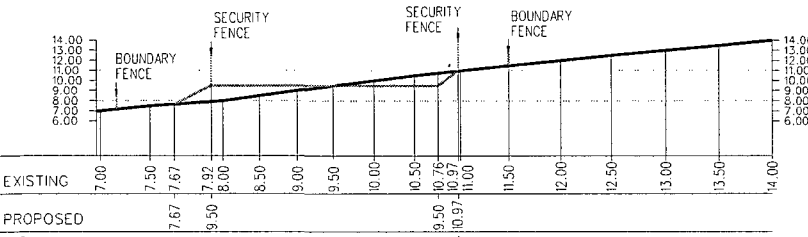

LINE 4
REGULATOR COMPOUND

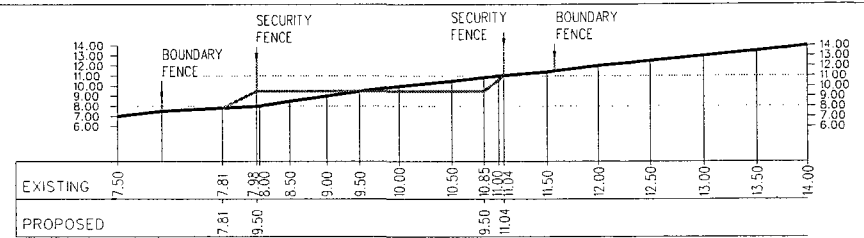

LINE 5
REGULATOR COMPOUND

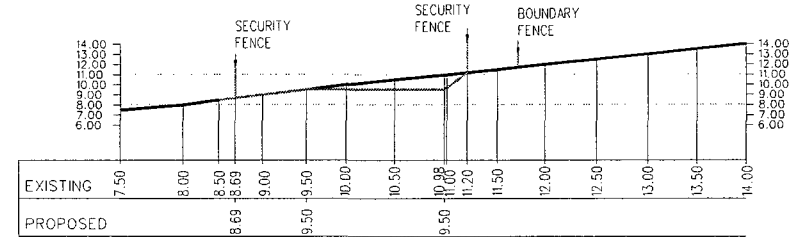

LINE 6
REGULATOR COMPOUND

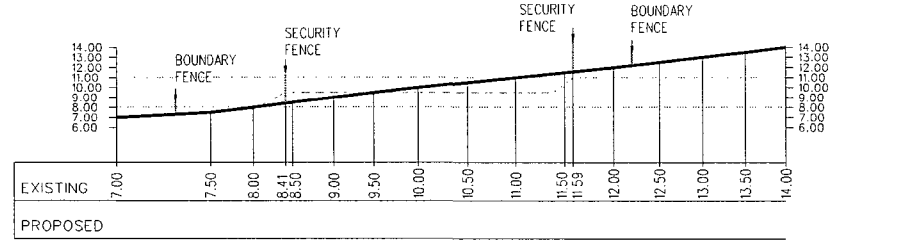

LINE 7
REGULATOR COMPOUND
EAST SECURITY FENCE

FOR PROFILE LOCATIONS SEE SITE PLAN DRG C69882/L/001
FOR PIG TRAP COMPOUND PROFILES SEE DRG C69882/L/002 SHEET 2

LEGEND
— EXISTING PROFILE
— PROPOSED PROFILE



B A	190210 241209	GH GH	DRAWING AMENDED TO 2 SHEETS ISSUED FOR INFORMATION	CHK'D	APP'D	SITE / PROJECT		DATE 24/12/09	DRWN GH	CHK'D	APPR'D
						SOLENT TRANSIT PIPELINE PROJECT		SCALE 1:500	A3	© Copyright of Scotia Gas Networks Ltd	
TITLE						EXTERNAL REFERENCE		REV.			
GURNARD AGI PRELIMINARY SITE PROFILES PROFILE SECTIONS SHEET 1 - REGULATOR COMPOUND						DRAWING No. C69882/L/002 - SHT 1		REV. A			



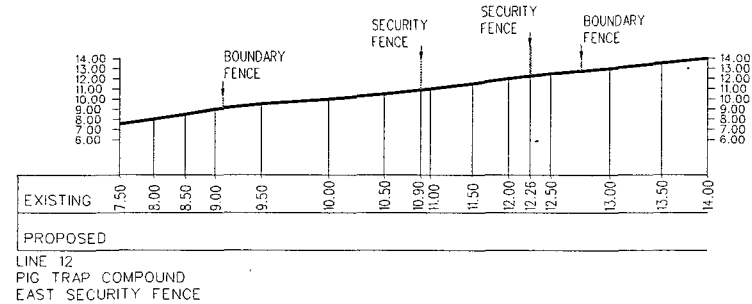
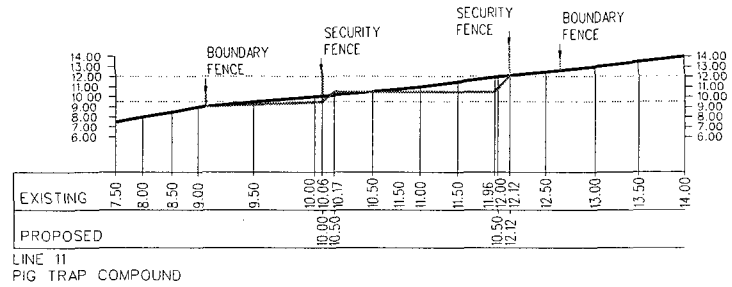
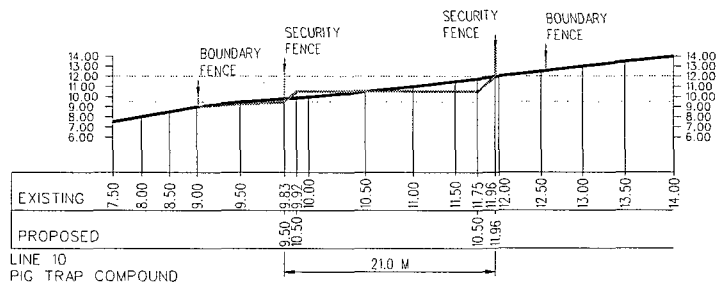
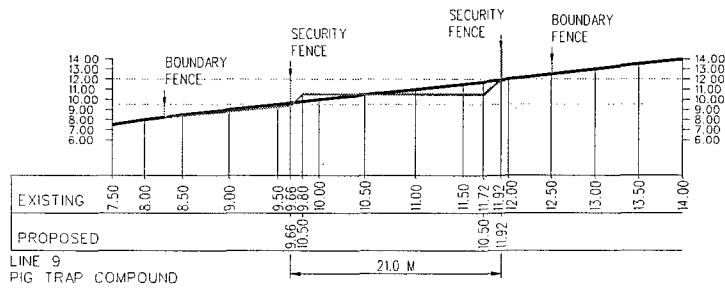
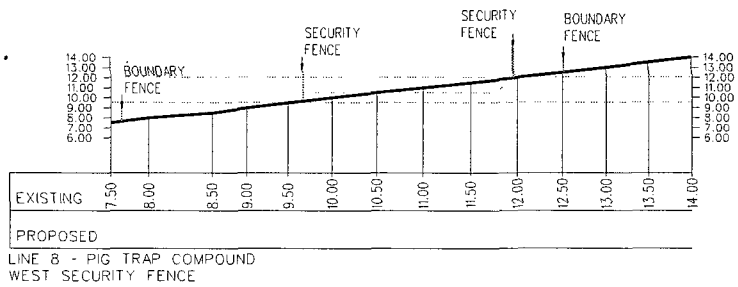

FOR PROFILE LOCATIONS SEE SITE PLAN DRG. C69882/L/001
FOR PIG TRAP COMPOUND PROFILES SEE DRG. C69882/L/002 SHEET 1

LEGEND
 — EXISTING PROFILE
 — PROPOSED PROFILE



B A	190210 24/12/09	GH GH	DRAWING AMENDED TO 2 SHEETS ISSUED FOR INFORMATION	SITE / PROJECT		DATE 24/12/09	DR'WN GH	CHK'D	APPR'D	
				SOLENT TRANSIT PIPELINE PROJECT		SCALE 1:500	A3	© Copyright of Scotia Gas Networks Ltd		
TITLE				EXTERNAL REFERENCE		REV.				
GURNARD AGI PRELIMINARY SITE PROFILES PROFILE SECTIONS				DRAWING No.		REV.				
REV	DATE	DR'WN	DESCRIPTION	CHK'D	APP'D	SHEET 2 - PIG TRAP COMPOUND		C69882/L/002 - SHT 2		A

